 <b>Tesla, Inc.</b> Service Bulletin		<h2 style="text-align: center;">Replace Instrument Panel Air Vent(s) due to Rattling Noise</h2>		
<b>SB-24-14-001</b> October 11, 2024	<b>R1</b>			
<b>Classification</b>		<b>Section/Group</b>	<b>Mobile Service</b>	<b>Configuration</b>
Repair Bulletin		14 - Instrument Panel	Cannot Perform	All
<b>Model</b>	<b>Model Year</b>	<b>Country/Region</b>	<b>Build Location</b>	
Model 3	2024	North America, Taiwan	Fremont	
<small>The model(s) and model year(s) listed are a general approximation of the affected VIN list. Refer to the VIN/Bulletin Tracker or Customer/Vehicle profile to determine applicability of this bulletin for a particular vehicle.</small>				

This repair bulletin provides instructions on addressing a possible customer concern regarding the operation of Tesla vehicle s. These instructions should only be performed by trained professionals.

*This Service Document supersedes SB-24-14-001, dated August 29, 2024. This new revision, R1, updates the air vent inspection steps. Each content change is marked by a vertical line in the left margin. Discard the previous version and replace it with this one.*

### Condition

On some 2024+ Model 3 vehicles built at Fremont, a rattling noise may be noticed from the driver and/or front passenger instrument panel air vent while the face-level air vents are directed to straight ahead air flow.

### Correction

Upon customer complaint, inspect the vehicle for symptoms related to the condition. If symptoms are present, replace the affected air vent(s).

Correction Description	Correction	Time
SB-24-14-001 Not Applicable	S012414001	0.00
Inspect Instrument Panel Air Vents; Symptoms Not Found	S022414001	0.30
Inspect And Replace Driver Instrument Panel Air Vent	S032414001	1.44
Inspect And Replace Front Passenger Instrument Panel Air Vent	S042414001	1.44
Inspect And Replace Driver And Front Passenger Instrument Panel Air Vents	S052414001	1.50

Part Number	Description	Quantity
<b>Parts Required</b> 1774505-05-E	IP, AIR, VENT, DRIVER, ASY	1
1774506-05-E	IP, AIR, VENT, PASSENGER, ASY	1

These part numbers were current at the time of publication. Use the revisions listed or later, unless otherwise specified in the [Parts Catalog](#).

## Procedure

1. Touch the temperature button on the bottom of the touchscreen to display the main climate controls screen (Figure 1).



Figure 1

2. Set the air to flow from the face-level air vents only, and touch and drag the radiating air waves from the vents on the touchscreen to adjust the direction of the air flow to centered and straight ahead (Figure 2).

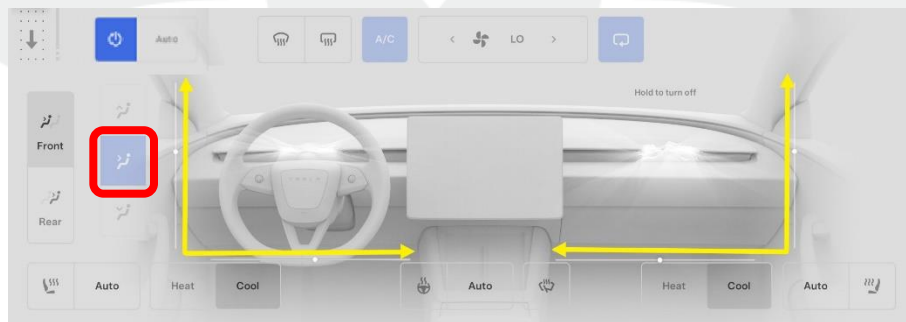

Figure 2

**NOTE:** The air flows in a merged single stream when centered or splits into mirrored air streams when air is directed outward or inward from the center of the vent. Make sure both air flows are set to “Merged” (Figure 3) and not to “Split” (figure 4).

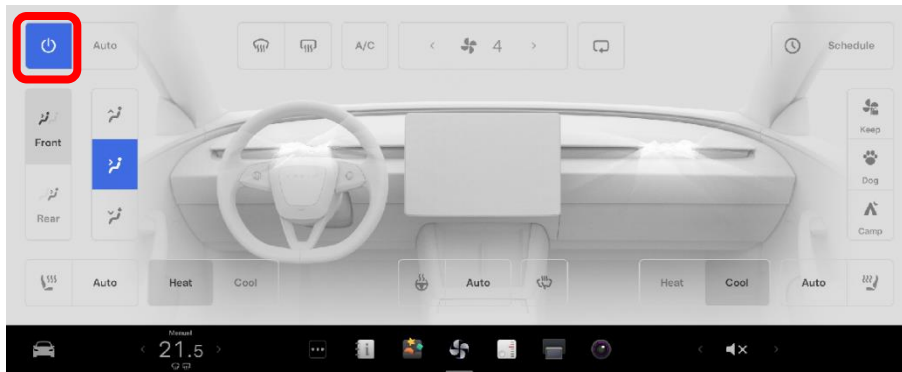

Figure 3 – Both air flows set to “Merged”



Figure 4 – Driver air flow set to “Split”, passenger air flow set to “Merged”

3. Turn off the climate system (Figure 5).



**Figure 5**

4. Take the vehicle for a test drive and perform the following sub-steps while driving to check for a rattling noise coming from the driver and/or front passenger air vent:
  - a. If a rattling noise is noticed from one or both air vents, turn on Climate Control, adjust the direction of the air flow through the air vents towards the outboard sides of the vehicle (Figure 6), and then turn off Climate Control again.

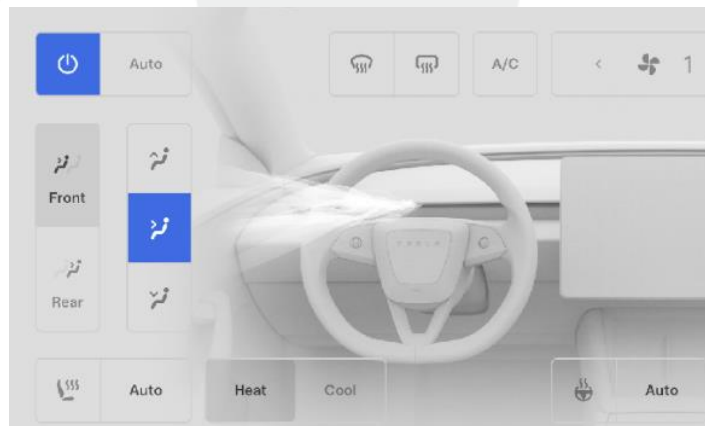

**Figure 6 – Merged air flows directed to the side of the vehicle**

- b. Turn on Climate Control, move the direction of the air flow back to the center position and in an upward direction, and then turn off Climate Control again.
- c. Repeat the previous step with the air flow directed completely downward.

5. Compare the level of the rattling noise between the different air flow direction settings from the air vents.
- If there is no difference in rattling noise when adjusting the air flow horizontally and vertically, discontinue this procedure and continue further diagnosis. Use correction code S022414001.
  - If the rattling noise from the respective air vent is found to have diminished after adjusting the air flow horizontally and/or vertically, this bulletin applies to the air vent. Replace the respective air vent(s) accordingly:
    - If the rattling noise was noticed from the driver side air vent only, replace the driver instrument panel air vent and use correction code S032414001.
    - If the rattling noise was noticed from the front passenger side air vent only, replace the front passenger instrument panel air vent and use correction code S042414001.
    - If the rattling noise was noticed from both the driver and front passenger air vents, replace the driver and front passenger instrument panel air vents and use correction code S052414001.

For instrument panel air vent replacement instructions, refer to Service Manual procedure [1405030052](#).



**NOTE:** Although the Service Manual procedure describes the replacement of the driver side instrument panel air vent, the replacement procedure is similar for the front passenger instrument panel air vent.